

# GREEN INITIATIVES AT CENTRAL PARK



Central Park will exemplify the latest practices in energy and water sustainability in urban development, creating an environment that stands the test of time. Central Park's sustainability partner is the Institute for Sustainable Futures at the University of Technology, Sydney. Social sustainability strategy by Elton Consulting.

## POWER INITIATIVES:

Central Park will house its own central thermal plant and tri-generation power station, using low-emission gas to produce electricity, heating and cooling. Stage 1 of the (CTEP), now under construction beneath the Brewery Yard building, will provide 2MW of tri-generation capacity, producing low-carbon thermal energy and providing heating and cooling for 3000 residences and 65,000 sqm of retail and commercial space across up to 14 buildings. The potential for excess power to be exported is now being investigated.

- The 2MW plant is projected to reduce greenhouse gas emissions by 190,000 tonnes over the 25 year design life of the plant. This is the same effect as removing 62,500 cars from our roads.
- The CTEP will vent filtered steam via the heritage chimney stack.



## WATER INITIATIVES:

Central Park will have its own water recycling plant operated by the Water Factory Company (opening December 2013). The plant will collect rain water, grey water and black water for treatment and re-use in laundries, toilets and gardens. The water factory will supply 100% of non-potable water needs at Central Park. Excess recycled water may be exported.

- Residents will pay less for recycled water than potable water.
- Sustainability targets include 100% capture and re-use of rainwater falling on rooftops.

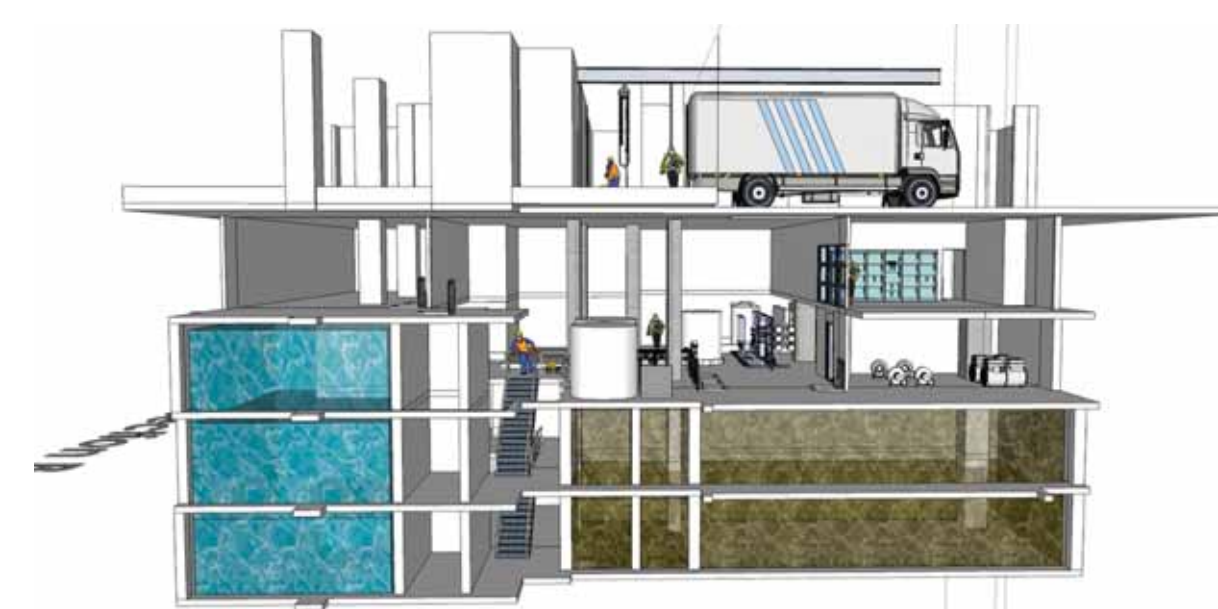

## OTHER INITIATIVES:

- Each building within Central Park will achieve minimum a 5 star rating (where a rating tool applies) under the Green Building Council of Australia's rating system.
- Best practice waste and material strategy. Achieved 93% recycling of demolition materials, making Central Park one of the largest recycling projects in Australia.
- One Central Park is a visibly 'green' building, with 24 vertical gardens covering 1200sqm of the facades, and 7 linear kilometers of planter boxes wrapping both towers (covering 3350sqm). These gardens use recycled water from the water recycling plant.
- Smart metering to all apartments for monitoring of energy and water use by residents.
- 40+ vehicle car share fleet by GoGet.
- Support for affordable housing via a \$32 million contribution to the Redfern Waterloo Authority and provision for 828 specialised student housing dwellings under the National Rental Affordability Scheme (NRAS).

